

**STAINLESS STEEL / ON-OFF
FREE FLOW / PNEUMATIC VALVE
BUTT WELDED**

SERIES : 301

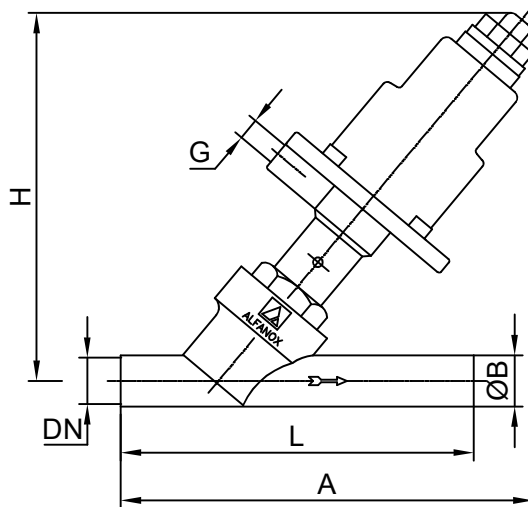

APPLICATION

Controls the flow of fluid, steam or gas in the system with the applied pressure.(On-off motion)

SIZES

DN 15 (1/2") / DN 50 (2")

WORKING CHARACTERISTICS

Working pressure (Δp) : Check the chart. (If you need higher working pressures let us know)

Maximum working pressure: 40 bar

Control type: NC - Normally Closed (Standard)

NO - Normally Open (Optional)

DA - Double Acting (Optional)

Control pressure : Minimum 5 bar - Maximum 10 bar

(You can optionally chose lower control pressures)

Fluid temperature : -10°C / 220°C"

Control air temperature : -10°C / 60°C

Connection type : Butt welding ends

Connection position : On the direction of the arrow / Can be connected horizontally or vertically

DN		PISTON	Δp bar	L	A	H	ØB	G	KV m³/h	WEIGHT (KG)
15	1/2"	Ø 50	21	126	155	145	21,3	G 1/8"	4,9	1,50
		Ø 63	33		170	170				1,80
20	3/4"	Ø 50	12	145	160	150	26,9		7,6	1,70
		Ø 63	27		175	175				2,00
25	1"	Ø 50	7	155	170	160	30,5		13,7	1,70
		Ø 63	12		185	185				2,10
		Ø 80	27		195	190				2,70
32	1 1/4"	Ø 63	7	175	185	180	42,4		20,7	2,50
		Ø 80	12		195	195				3,10
		Ø 100	26		210	205				4,30
40	1 1/2"	Ø 63	5	195	210	200	48,3		34,2	3,20
		Ø 80	8		220	210				3,90
		Ø 100	16		240	230		5,00		
50	2"	Ø 80	5	225	230	220	60,3	48,6	4,70	
		Ø 100	10		250	240			5,80	



ALFANOX

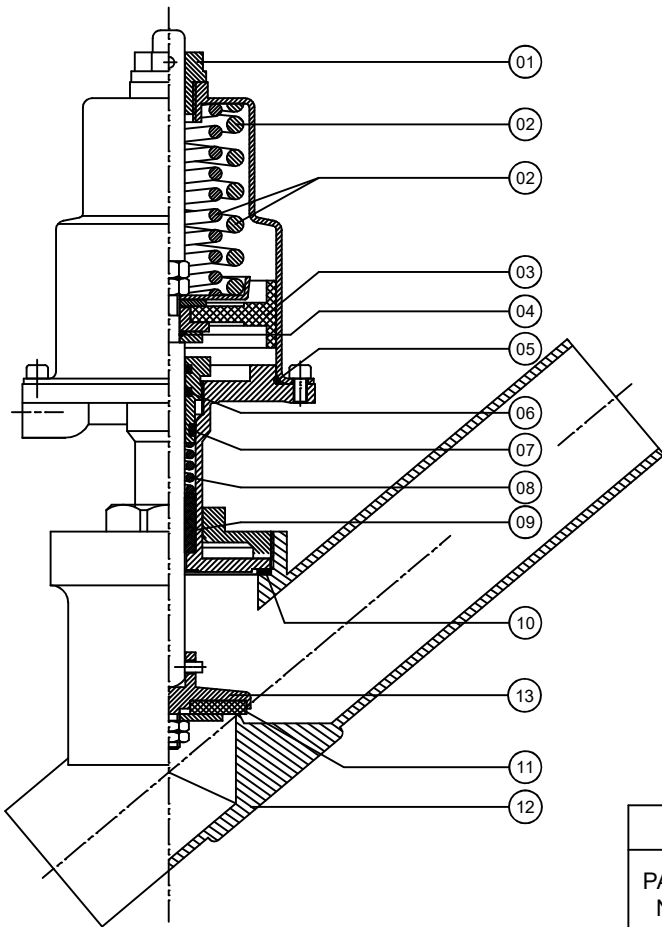

INSTRUCTIONS :

1. Valve can be fitted in any position.
2. Flow direction should be as indicated by an arrow on the body.
3. Working pressure for each size of valve should not be exceed the limits indicated in the chart.
4. Control pressure should not exceed the maximum and should not go lower then the minimum value.
5. CAUTION : Never fasten or remove the assembly nut prior to applying pressurized air.

For the spare part orders, notifying us about the part number at the chart below and also the serial number on the valve are adequate.

SPARE PART LIST		
PART NO	PART NAME	MATERIAL
01	UPPER SPINDLE GUIDE	NYLON 66
02	SPRING (SINGLE)	INOX
02	SPRING (DOUBLE)	INOX
02	SPRING (DOUBLE)	STEEL
03	PISTON GROUP	NBR+BRASS
04	PISTON O-RING	NBR
05	CYLINDER O-RING	SILICONE
06	STUFFING BOX O-RING	SILICONE
07	STUFFING BOX GASKET	SILICONE
08	STUFFING BOX SPRING	INOX
09	STUFFING BOX V-CHEVRON	PTFE
10	BODY SEALING GASKET	PTFE / SILICONE
11	SEAT SEAL	EPDM / PTFE / VITON
12	VALVE BODY	AISI 316
13	SEAT SEAL HOLDER	AISI 316

